

# 1/4-14 Type B Self-tapping Metal to Metal Fastener

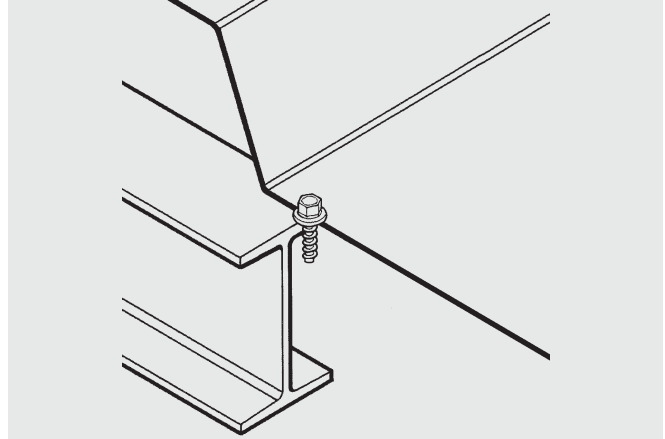

## Features and Benefits

- Zinc plated carbon steel
- Available with no sealing washer or with bond seal washer
- Long lengths available for specialty applications

## Application

Metal panel to medium and heavy gauge metal applications

## Product Selection

Material No.	Fastener Length		Thread Length*	Min Load Bearing Length		Max Load Bearing Length		Description	Carton Wt. (lbs.)	Carton Qty.
	(in)	(mm)		(in)	(mm)	(in)	(mm)			
784198	3/4"	19	Full	n/a	n/a	0.40"	10	TB-#14x3/4-H3/8-GB19/32	39	2,500
784208	1"	25	Full	n/a	n/a	0.64"	16	TB-#14x1-H3/8-GB19/32	44	2,500
784232	1-1/2"	38	Full	n/a	n/a	1.14"	29	TB-#14x1-1/2-H3/8-GB19/32	44	2,000
784241	2"	51	Full	n/a	n/a	1.64"	42	TB-#14x2-H3/8-GB19/32	38	1,500
784248	2-1/2"	64	Full	n/a	n/a	2.14"	54	TB-#14x2-1/2-H3/8-GB19/32	23	750
784253	3"	76	2-7/8"	0.34"	9	2.64"	67	TB-#14x3-H3/8-GB19/32	27	750
784258	3-1/2"	89	2-7/8"	0.84"	21	3.14"	80	TB-#14x3-1/2-H3/8-GB19/32	37	1,000
784262	4"	102	2-7/8"	1.34"	34	3.64"	93	TB-#14x4-H3/8-GB19/32	21	500
784268	5"	127	2-7/8"	2.34"	59	4.64"	118	TB-#14x5-H3/8-GB19/32	26	500
784273	6"	152	2-7/8"	3.34"	85	5.64"	143	TB-#14x6-H3/8-GB19/32	28	500

Plain product bulk carton packed, unless otherwise noted.

\*Note – Thread length measured from tip of point to top of the threads.



# 1/4-14 Type B Self-tapping Metal to Metal Fastener

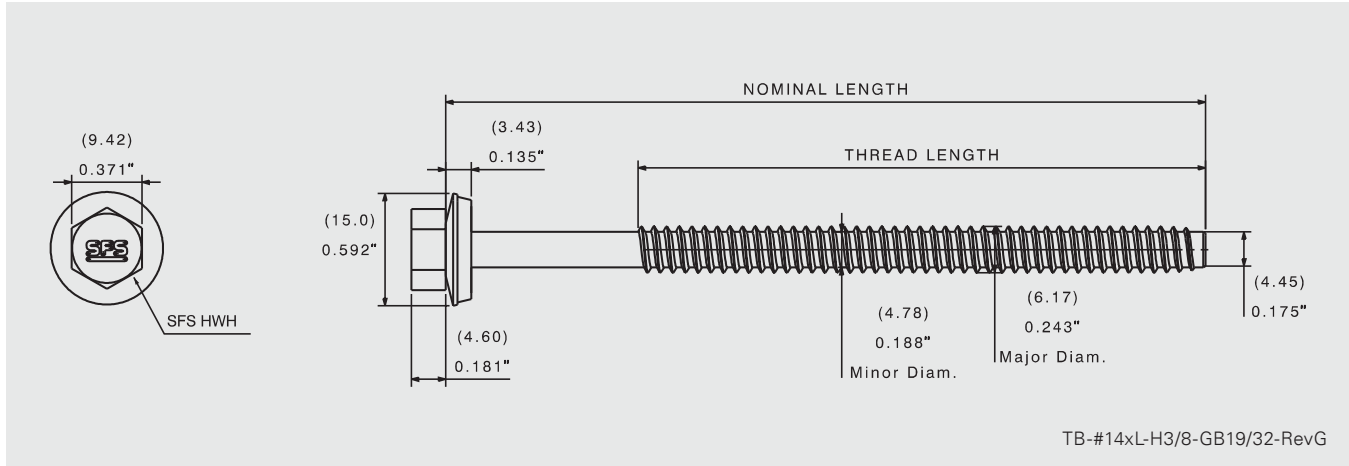

## Product Specifications

Diameter: 1/4" (6.17 mm)  
 Threads Per Inch: 14  
 Head Style: 3/8" dia. HH AF (9.42 mm)  
 Washer: 19/32" galvanized and EPDM bond seal (15 mm)

Drill Point: Type B  
 Drill Capacity: 0.044"–0.500" (1.12 mm–12.7 mm)  
 Thread Major Dia: 0.243" (6.17 mm)  
 Thread Minor Dia: 0.188" (4.78 mm)

## Performance Data<sup>1,2,3</sup>

### Material Strength

Tensile	3800 lbf / 16903 N
Shear	2560 lbf / 11387 N
Torsional	142 lbf·in / 16.04 N·m

### Pull Out Strength Steel

<b>16 Ga (1.5 mm)</b>	879 lbf / 3910 N
<b>14 Ga (1.9 mm)</b>	1277 lbf / 5680 N
<b>12 Ga (2.7 mm)</b>	2185 lbf / 9719 N

### Pull Over Strength Steel

<b>26 Ga (0.5mm)</b>	616 lbf / 2740 N
<b>24 Ga (0.6mm)</b>	884 lbf / 3932 N
<b>22 Ga (0.8mm)</b>	1079 lbf / 4799 N

<sup>1</sup> Pull out values are based on 45 ksi cold formed sheet metal.

<sup>2</sup> SFS [5625.19, 4812.11]

<sup>3</sup> S-120, SC3

## Installation and Application Considerations

Tools: 0–1000 rpm screw gun equipped with depth sensing nose piece.

**Use of impact guns or hammer drills is not recommended.**

Metal thickness	Drill bit size
0.065"–0.085" (1.65 mm–2.16 mm)	#8 (5.05 mm)
0.085"–0.115" (2.16 mm–2.92 mm)	#7 (5.11 mm)
0.115"–0.375" (2.92 mm–9.53 mm)	#1 (5.79 mm)
0.375"–0.500" (9.53 mm–12.7 mm)	#1 or larger depending on hardness of steel

The hole size determines installation performance and pull out strength. Thickness is based on normal, single thickness purlin/girt or multiple material thickness combined for total.

Fastener length should provide for a minimum of 3/16" penetration of fully developed threads into metal substrate.